



8, HILLVIEW, SKELMORLIE, PA17 5BE



 neillclerk
ESTATE AGENTS



Description

Closing date on Thursday 5th September at 11am

This three bedroom END TERRACED VILLA is an ideal family home within a desirable cul de sac location close to the countryside. A driveway provides essential off street parking. There is a south facing rear garden with paved and lawned sections, plus timber shed to the side of the property. The front garden has a paved path leading to the entrance with lawn to either side.

Specification includes: partial double glazing and gas central heating, transport facilities, plus the centre of village with its local shops and amenities is nearby.

Apartments comprise: Hallway by double glazed UPVC door with front window. There is a Cloakroom/Utility Store which could be converted into a home office. The bright dual aspect Lounge features windows to the front and rear with inset electric fire. The generous sized Dining Kitchen offers white high gloss units, blue toned granite style work surfaces and matching splashback. Appliances include: extractor hood, electric gas hob, electric oven, washing machine dishwasher and integrated microwave. A UPVC double glazed door gives access to the rear garden.

Stairs lead to the Upper Landing with rear window and hatch to the loft. There are two double sized Bedrooms and 3rd single Bedroom. The 1st bedroom benefits from oak style fitted wardrobes and matching chest of drawers. Bedroom 3 offers fitted mirrored wardrobes and an inbuilt cupboard. The Shower Room with rear window comprises: vanity wash hand basin set within white high gloss unit, wc and double sized shower cubicle with "Mira" shower plus wall tiling.

Viewing is essential for this three bedroom family home. EPC = D

Measurements

Entrance Hall

Cloakroom/Utility Store
1.83m x 1.88m (6'0 x 6'2)

Lounge
3.20m x 5.72m (10'6 x 18'9)

Kitchen
3.78m x 3.68m (12'5 x 12'1)

Upper Landing

Bedroom 1
2.84m x 2.72m (9'4 x 8'11)

Bedroom 2
4.19m x 3.91m (13'9 x 12'10)

Bedroom 3
1.73m x 3.00m (5'8 x 9'10)

Shower Room

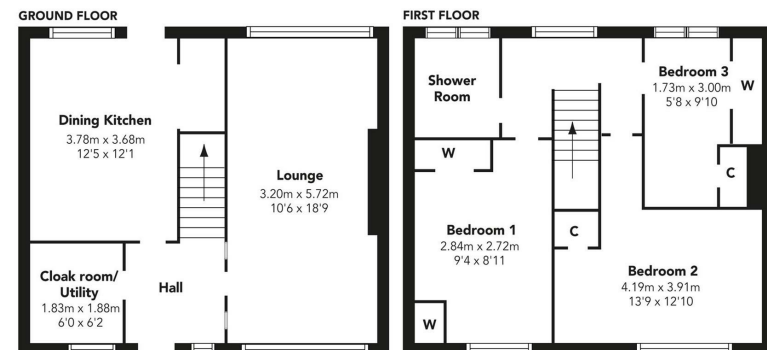

Floorplans are indicative only - not to scale
Produced by Plushplans 











Agents Notes:

These sales particulars are set out as a general outline only, issued in good faith, but do not constitute representations of fact and do not form part of any offer or contract. Any services, equipment, appliances, fittings or central heating systems have not been tested and no warranty is given or implied that these are in working order. All measurements are approximate and for guidance only.

Neither Neill Clerk Estate Agents nor any of its employees or agents has any authority to make or give any representation or warranty whatever in relation to this property.

The
next
step..



To view call 01475 888400. Speak to us 7 days a week until 11pm every day to book your viewing appointment.

House to sell or rent?

Call 01475 888400 to book your free market appraisal.

Require a solicitor?

Ask us to supply a free legal quotation from Neill Clerk & Murray, Solicitors.
www.neillclerkmurray.co.uk

Stay fully up-to-date by following Neill Clerk on:



**60 West Blackhall Street
Greenock
Renfrewshire
PA15 1UY**

t: 01475 888400

e: sales@neillclerk.co.uk

w: www.neillclerk.co.uk



Find all our properties at: [rightmove](https://www.rightmove.co.uk) [Zoopla](https://www.zoopla.co.uk) [onTheMarket.com](https://www.onthemarket.com) [s1homes.com](https://www.s1homes.com)